

EUROFLO[®] CULVERT PIPE

Fittings / Pipes

F



EUROFLO® FITTINGS

RUBBERS



SIZE	CODE	COMMENT
160mm OD	520-160-RBR	Suits SN4 + SN8
200mm OD	520-200-RBR	
250mm OD	520-250-RBR	
315mm OD	520-315-RBR	
400mm OD	520-400-RBR	
500mm OD	520-500-RBR	
630mm OD	520-630-RBR	
800mm OD	520-800-RBR	
1000mm OD	520-1000-RBR	
1200mm OD	520-1200-RBR	
1550mm OD	520-1550-RBR	
1750mm OD	520-1750-RBR	
1950mm OD	520-1950-RBR	

SEALING ADAPTORS



SIZE	CODE	COMMENT
160mm ID	521-2430-160	
200mm ID	521-2430-200	

HOLESAW



SIZE	CODE	COMMENT
110mm OD	521-2431-110	Holesaw Only
160mm OD	521-2431-160	Holesaw Only
200mm OD	521-2431-200	Holesaw Only
110mm	521-2432-11	Arbor for Holesaw
160/200mm	521-2432-16	Arbor for Holesaw

Key

All Item DWV unless noted
M+F = Male, Female Ends

DWV= Drain Waste and Vent
F+F= Female, Female Ends

SW= Storm Water
ADJ= Adjustable

SEALING RINGS



SIZE	CODE	COMMENT
110mm ID	521-2439-110	
160mm ID	521-2439-160	
200mm ID	521-2439-200	

REDUCERS



SIZE	CODE	COMMENT
315mm x 250mm	521-315-250	
400mm x 250mm	521-400-250	
400mm x 315mm	521-400-315	
500mm x 400mm	521-500-400	

BENDS AND JUNCTIONS



SIZE	CODE	COMMENT
315mm x 15°	571-315-15	M+F
315mm x 30°	571-315-30	M+F
315mm x 45°	521-315-45	
315mm x 90°	521-315-90	
400mm x 45°	521-400-45	
400mm x 45°	521-400-45J	Junction
400mm x 90°	521-400-90	
500mm x 45°	521-500-45	
500mm x 90°	521-500-90	
630mm x 45°	521-630-45	
630mm x 90°	521-630-90	

Note: Other fittings can be made to order

Key

All Item DWV unless noted
M+F = Male, Female Ends

DWV= Drain Waste and Vent
F+F= Female, Female Ends

SW= Storm Water
ADJ= Adjustable

EUROFLO® PIPE

5.8 metre lengths overall including socket
Rubber ring joint if needed - see fittings page for codes for the rubber rings
SN16 stiffness available to order



PRODUCT CODE	DESCRIPTION	SN RATING	CRATE QTY	NOMINAL BORE (MM)	OUTSIDE DIAMETER (MM)
520-160-5.8M	160mm Culvert Pipe Euroflo	SN8	33	150	160
520-200-5.8M	200mm Culvert Pipe Euroflo	SN4	18	180	200
520-250-5.8M	250mm Culvert Pipe Euroflo	SN4	11	220	250
520-315-5.8M	315mm Culvert Pipe Euroflo	SN4	6	280	315
520-400-5.8M	400mm Culvert Pipe Euroflo	SN4	3	350	400
520-500-5.8M	500mm Culvert Pipe Euroflo	SN4	2	430	500
520-630-5.8M	630mm Culvert Pipe Euroflo	SN4	1	530	630
520-800-5.8M	800mm Culvert Pipe Euroflo	SN4	1	640	800
520-1000-5.8M	1000mm Culvert Pipe Euroflo	SN4	1	850	1000
520-1200-5.8M	1200mm Culvert Pipe Euroflo	SN4	1	1030	1200
520-1550-5.8M	1550mm Culvert Pipe Euroflo	SN2	1	1400	1550
520-1750-5.8M	1750mm Culvert Pipe Euroflo	SN2	1	1600	1750
520-1950-5.8M	1950mm Culvert Pipe Euroflo	SN2	1	1800	1950
520-2150-5.8M	2150mm Culvert Pipe Euroflo	SN2	1	2000	2150



Key

All Item DWV unless noted
M+F = Male, Female Ends

DWV= Drain Waste and Vent
F+F= Female, Female Ends

SW= Storm Water
ADJ= Adjustable

EUROFLO® PIPE

NEW SN8 Rating

5.8 metre lengths overall including socket

Rubber ring joint if needed - see fittings page for codes for the rubber rings



PRODUCT CODE	DESCRIPTION	SN RATING	CRATE QTY	NOMINAL BORE (MM)	OUTSIDE DIAMETER (MM)
560-250-5.8M	250mm Culvert Pipe Euroflo	SN8	11	220	250
560-315-5.8M	315mm Culvert Pipe Euroflo	SN8	6	280	315
560-400-5.8M	400mm Culvert Pipe Euroflo	SN8	3	350	400
560-500-5.8M	500mm Culvert Pipe Euroflo	SN8	2	430	500
560-630-5.8M	630mm Culvert Pipe Euroflo	SN8	1	530	630
560-800-5.8M	800mm Culvert Pipe Euroflo	SN8	1	640	800
560-1000-5.8M	1000mm Culvert Pipe Euroflo	SN8	1	850	1000
560-1200-5.8M	1200mm Culvert Pipe Euroflo	SN8	1	1030	1200

FLUMING (HALF PIPE)

5.8 metre lengths overall including socket

PRODUCT CODE	DESCRIPTION
520-250-FLUM	250mm Fluming Half Pipe
520-315-FLUM	315mm Fluming Half Pipe
520-400-FLUM	400mm Fluming Half Pipe
520-500-FLUM	500mm Fluming Half Pipe
520-630-FLUM	630mm Fluming Half Pipe
520-800-FLUM	800mm Fluming Half Pipe
520-1000-FLUM	1000mm Fluming Half Pipe
520-1200-FLUM	1200mm Fluming Half Pipe



Key

All Item DWV unless noted
M+F = Male, Female Ends

DWV= Drain Waste and Vent
F+F= Female, Female Ends

SW= Storm Water
ADJ= Adjustable

EUROFLO[®] SLOTTED PIPE



BENEFITS:

Euroflo Slotted Pipe allows you to fill in open drains without losing any ground drainage. Eliminate stock losses and comply with your environmental responsibilities to protect waterways.

- » Quick and easy to lay, especially when compared to drain coil.
- » Available in **LARGE DIAMETERS - up to 630mm**
- » Light and safe to handle
- » Ideal replacement for old large diameter clay pipes
- » Suits all standard PVC Bends, Y's, Tees, etc.
- » Use economical Euroflo Go-In System to tee into larger diameter pipes

FEATURES:

- » Strong and robust
- » Subsoil drainage of surface and water table
- » Will not rust
- » Resist a wide range of chemicals from very acidic to very alkaline

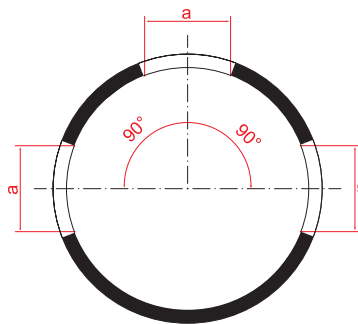

Standard Pattern
3-5 slots depending on size
Total slotted angle = 240°

SLOTTED PIPE

5.8 metre lengths overall including socket

PRODUCT CODE	DESCRIPTION	SN RATING	CRATE QTY	NOMINAL BORE (MM)	OUTSIDE DIAMETER (MM)
590-160-5.8M	160mm Slotted Drainage Pipe		33	150	160
590-200-5.8M	200mm Slotted Drainage Pipe		18	180	200
590-250-5.8M	250mm Slotted Drainage Pipe		11	220	250
590-315-5.8M	315mm Slotted Drainage Pipe		6	280	315
590-400-5.8M	400mm Slotted Drainage Pipe		3	350	400
590-500-5.8M	500mm Slotted Drainage Pipe		2	430	500
590-630-5.8M	630mm Slotted Drainage Pipe		1	530	630

EUROFLO® GO-IN SYSTEM



COMPONENTS:

1. Hole Saw (sold separately or hired)
2. Seal Insert
3. Special fitting (for connecting branches over 125mm OD)
4. Gasket (sold separately)

BENEFITS:

- » Branches can be simply installed after main pipe placement
- » Extremely cost effective
- » Can be installed vertically even when water is flowing
- » Fast and user-friendly
- » Adaptable for branches of either ribbed PE or smooth PVC

USES:

- » Breather pipe connections
- » Field drain connections to main drain
- » Connections into Sumps and Gallery's

INSTALLATION:

Drill through top centre of corrugation at right angles to pipe axis.

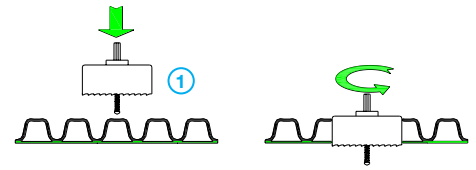

Insert Seal fully into hole.

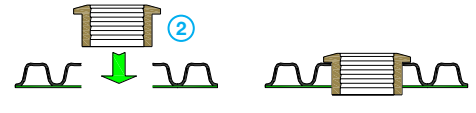

Lube inside of seal and insert Special Fitting.

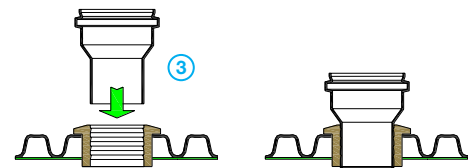

OR

If under 125mm OD insert branch directly into Seal Insert.

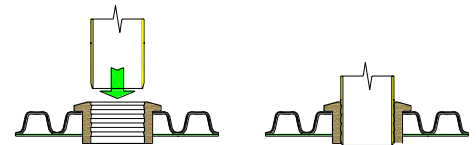

For Euroflo branch fit standard sealing ring (as for Euroflo pipe connection), and insert pipe spigot into Special Fitting.

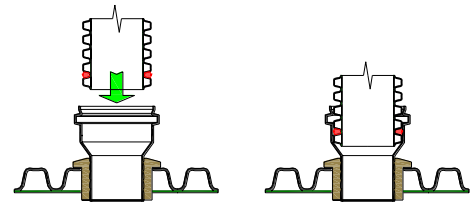

For smooth PVC or PE branch, fit Gasket, lubricate, then insert branch.

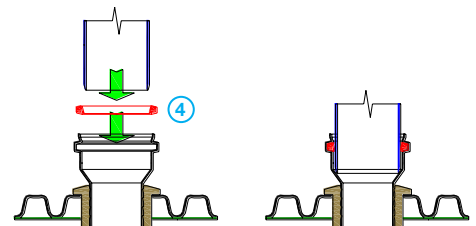

DN OF BRANCH PIPE IN MM

MINIMUM ID OF MAIN PIPE IN MM

110mm

250mm

160mm

350mm

200mm

400mm

EUROFLO® CULVERT PIPE

BENEFITS:

- > Easy to handle
- > Smooth bore = flow faster, less silt build-up
- > Maintenance-free life span
- > Rust free
- > Resists chemically aggressive soil conditions

TECHNICAL DATA:

- > Nominal stiffness SN4 and SN8 (stocked) SN16 available on request
- > Socket one end
- > HDPE (Polyethylene)
- > 5.8M standard length
- > Sizes are outside diameter of pipe

USES:

- > Farm culverts
- > Forestry culverts
- > Cut in 1/2 lengthways for stock troughs, fluming
- > Highway culverts
- > Mine culverts

TIPS:

- > Project end of pipe to prevent erosion of backfill downstream
- > Timber, stone or grass headwalls to prevent erosion upstream
- > No sharp objects in contact with pipe when laying or backfilling
- > Socket end of pipe to face upstream

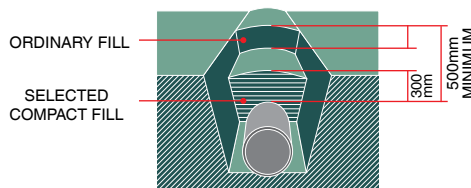
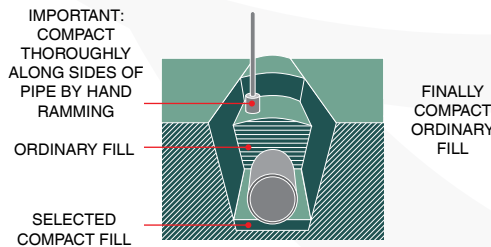
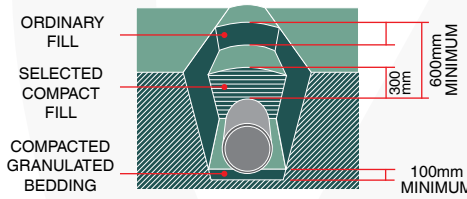
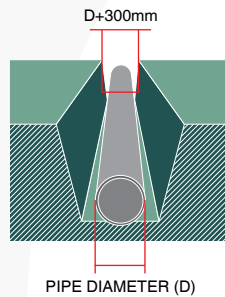

INSTALLATION:

EXCAVATION

Dig a trench 300mm wider than the pipe. Ideal depth of cover is 600mm.

PIPE LAYING

Bedding to be 5-20mm compacted granular material. Lay pipe in centre of trench. Selected compactible fill (not wet clay) added in layers around pipe to 300mm cover. Top up trench with compacted ordinary fill.

COMPACTION OF BEDDING

EUROFLO™ pipe uses its flexibility to transfer load to the surrounding bedding. Thorough compaction of the fill along the pipe sides is important to ensure long, trouble free service. Fill should be carefully compacted by hand ramming along the sides of and around the pipe and built up to the finished ground surface.

LIGHT DUTY INSTALLATION

Selected excavation fill may be used as bedding. It should be substantially free from rock, tree roots or rubbish. Wet or saturated clay shouldn't be used as bedding or surrounding material. The minimum depth of cover should be 500mm.

SUPPLIER: